

How to secure iPad with a Passcode and Auto-Lock

Open up Settings

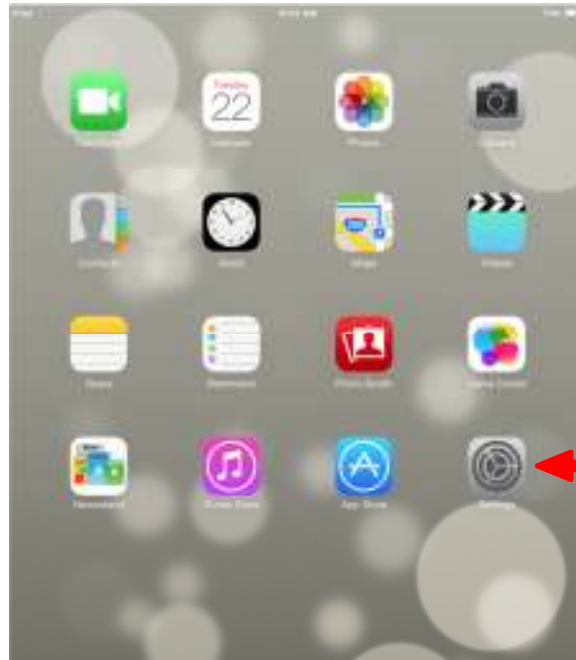

Click on Passcode (1), then click on Turn Passcode On (2)

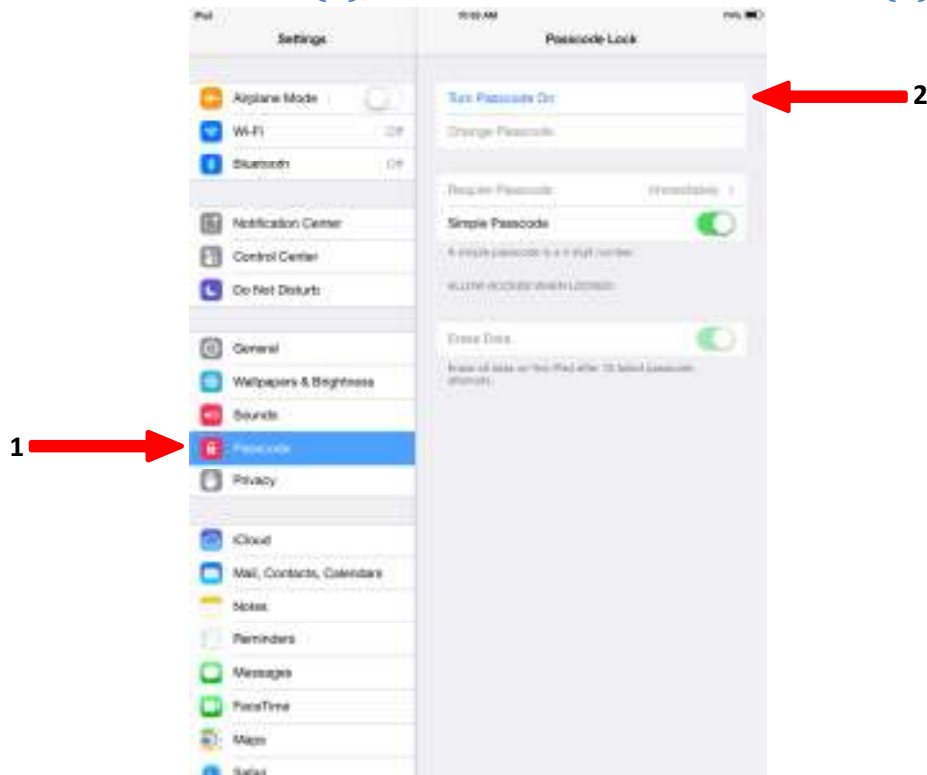

Choose and enter a passcode when prompted as shown below. You will have to enter this twice, do not forget this passcode as your iPad will be locked if you forget it.



Next, click on *General* then select *Auto-Lock* to set a time for your iPad to lock itself after a period of inactivity. Two minutes is recommended.

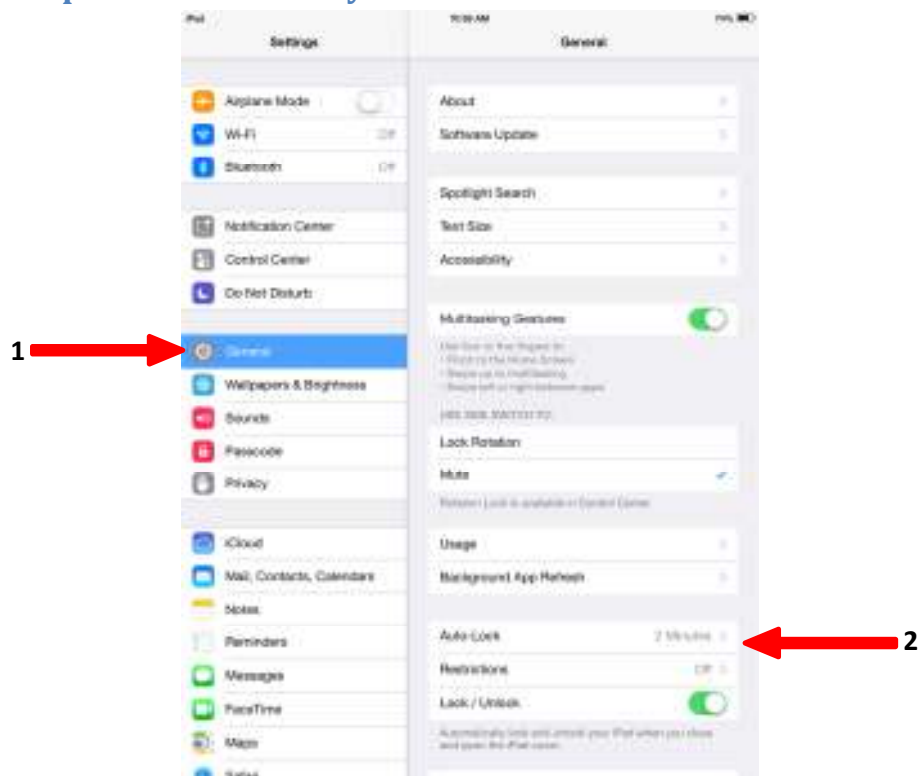

After increasing the security on your iPad, below is the screen where you will enter the passcode to use your iPad.

